

Model : COMBO
Moisture Separator



Technical Specifications:

Body:	Alluminium Die Cast
Cartridge	Imported S.S.
Size	1/4" & 1/2"
Working Pressure	Upto 10 Kg/cm ²
Testing Pressure	12 Kg/cm ²
Efficiency	99.99%
Service Life	Min. Exp. 3 to 5 Yrs.
Installation	Advisable at End Use Before FRL
Drain	Manual Ball Valve in 1/2" Manual Push type Valve in 1/4"

DIMENSIONS

(Dimensions are in mm)

Model	Size	SCFM	A	H	C	D	Weight (Kg) Approx
COMBO-01	1/4"	28	72	169	20	----	0.360
COMBO-02	1/2"	40	103	285	32	15	1.200

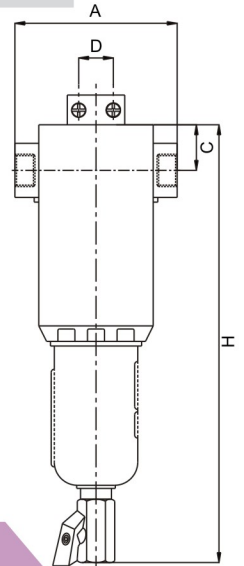

Model: SILVER
Moisture Separator



Technical Specifications:

Body:	Alluminium Die Cast
Cartridge	Imported S.S.
Size	1/2"
Working Pressure	Upto 10 Kg/cm ²
Efficiency	99.99%
Testing Pressure	12 Kg/cm ²
Installation	Advisable at End Use Before FRL

DIMENSIONS

(Dimensions are in mm)

Model	Size	SCFM	A	H	C	D	Weight (Kg) Approx
SILVER	1/2"	40	103	190	32	15	0.900

